

Doorslagbeveiligde machinevoeten DNV gecertificeerd

| Art.Code | L (mm) | Ls (mm) | K (mm) | D (mm) | H (mm) | B (mm) | M (mm) | d (mm) | Shore A |
|----------|-----------|------------|-----------|-----------|-----------|-----------|-----------|-----------|---------|
| 6014440S | 212 | 182 | 111 | 144 | 48 | 144 | M16i | 13,5 | 40° |
| 6014450S | 212 | 182 | 111 | 144 | 48 | 144 | M16i | 13,5 | 50° |
| 6014460S | 212 | 182 | 111 | 144 | 48 | 144 | M16i | 13,5 | 60° |
| 6014470S | 212 | 182 | 111 | 144 | 48 | 144 | M16i | 13,5 | 70° |

Indien gewenst is de machinevoet leverbaar met hoogteverstelling

- L = lengte
- Ls = hartafstand bevestigingsgaten
- K = diameter kap
- D = diameter
- H = hoogte
- B = breedte
- M = schroefdraad
- d = boring
- Shore A = hardheid

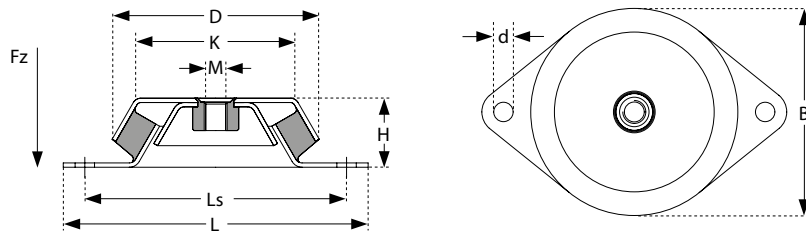

Belasting Fz

